



CoreLine SlimDownlight

DN145C LED20S/830 PSU II WH

CoreLine SlimDownlight, Surface-mounted, 21 W, D205 mm, 2100 lm, 3000 K, CRI>80, Opal, IP20/44

CoreLine slimdownlight delivers on the CoreLine promise of innovative, easy to use and high-quality indoor LED downlights. CoreLine slimdownlight is an innovative range of recessed and surface-mounted luminaires. It is designed to provide uniform lighting across multiple application areas. With instant energy savings and a longer lifetime, this is an environmentally friendly and cost saving solution. Its MultiColorTemp feature offers a choice of two color temperatures in a single luminaire. This makes it easy to select the right product, gives you the flexibility respond to customer preferences on site, and means fewer product codes on stock. Simple and easy installation means our slim downlight fits the same size cut-out, while the minimal built-in depth of 34mm makes this product an ideal space saving solution, especially for projects with limited fitting space. InterAct Ready option with integrated wireless communications in this family is available, to be used with InterAct gateways, sensors and software.

Product data

| General Information | | Value ladder | |
|--------------------------|--|------------------------|---|
| Lamp family code | LED20S [LED Module, system flux 2000 lm] | Serviceability class | Performance |
| Light source replaceable | No | Warranty period | Class C, luminaire without serviceable parts, not serviceable |
| Number of gear units | 1 unit | Sustainability rating | 5 years |
| Driver included | Yes | | - |
| Service tag | Yes | Light Technical | |
| Lighting Technology | LED | Luminous Flux | 2,100 lm |

CoreLine SlimDownlight

| | |
|------------------------------------|----------------|
| Saturated Red (R9) | <50 |
| Correlated Color Temperature (Nom) | 3000 K |
| Luminous Efficacy (rated) (Nom) | 100 lm/W |
| Color rendering index (CRI) | >80 |
| Number of light sources | 1 |
| Beam angle of light source | 120 degree(s) |
| Light source color | 830 warm white |
| Optic type | Beam angle 90° |
| Luminaire light beam spread | 84° |
| Unified glare rating CEN | 28 |

Operating and Electrical

| | |
|--|------------------------|
| Input Voltage | 220 to 240 V |
| Line Frequency | 50 or 60 Hz |
| Initial CLO power consumption | - W |
| Average CLO power consumption | - W |
| Inrush current | 28.9 A |
| Inrush time | 0.0016 ms |
| Power Consumption | 21 W |
| Power Factor (Fraction) | 0.9 |
| Connection | Connection unit 2-pole |
| Cable | - |
| Number of products on MCB of 16 A type B | 16 |
| Suitable for random switching | Yes |
| Protection class IEC | Safety class II |
| Total harmonic distortion | 20 % |

Controls and Dimming

| | |
|-------------------------------|----------------------------|
| Dimmable | No |
| Driver/power unit/transformer | Power supply unit (On/Off) |
| Control interface | - |
| Constant light output | No |
| Maximum dim level | Not applicable |

Mechanical and Housing

| | |
|------------------------------|--|
| Housing Material | Aluminum die cast |
| Reflector material | - |
| Optic material | Polymethyl methacrylate |
| Optical cover material | Polystyrene |
| Fixation material | - |
| Housing Color | White |
| Optical cover finish | Opal |
| Overall height | 50 mm |
| Overall diameter | 219 mm |
| Ingress protection code | IP20/44 [Finger-protected; wire-protected, splash-proof] |
| Mech. impact protection code | IK02 [0.2 J standard] |
| Optical cover type | Opal |
| Net Weight (Piece) | 0.830 kg |

Approval and Application

| | |
|---|--|
| Glow-wire test | Temperature 650 °C, duration 30 s |
| Flammability mark | For mounting on normally flammable surfaces |
| CE mark | Yes |
| ENEC mark | ENEC mark |
| Photobiological risk | Photobiological risk group 0 @200mm to EN62778 |
| EU RoHS compliant | Yes |
| Performance ambient temperature Tq | 25 °C |
| Remarks | *-Per Lighting Europe guidance paper "Evaluating performance of LED based luminaires - January 2018": statistically there is no relevant difference in lumen maintenance between B50 and for example B10. Therefore, the median useful life (B50) value also represents the B10 value. |
| Flickering value (PstLM) - Flickering value as per EN 61000-3-3 | 1 |
| Stroboscopic effect visibility measure (SVM) | 1.6 |
| Ambient temperature range | 0 to +35 °C |

Initial Performance (IEC Compliant)

| | |
|--|--------------------------|
| Luminous flux tolerance | +/-10% |
| Initial chromaticity | (0.43657,0.40454) SDCM<3 |
| Power consumption tolerance | +/-10% |
| Standard Deviation of Colour Matching (McAdam ellipse) | SDCM≤3 |

Over Time Performance (IEC Compliant)

| | |
|---|----------|
| Driver failure rate at 5000 h | 0.0015 % |
| Control gear failure rate at median useful life 50000 h | 5 % |
| Lumen maintenance (EN-IEC 62722-2-1) at median useful life* 50000 h | L70 |

Product Data

| | |
|---------------------------------|-----------------------------|
| Order product name | DN145C LED20S/830 PSU II WH |
| Full product name | DN145C LED20S/830 PSU II WH |
| Full product code | 871016333953599 |
| Order code | 911401806580 |
| Material Nr. (12NC) | 911401806580 |
| Numerator - Quantity Per Pack | 1 |
| EAN/UPC - Product/Case | 8710163339535 |
| Numerator - Packs per outer box | 10 |
| EAN/UPC - Case | 8710163339856 |

CoreLine SlimDownlight

Dimensional drawing

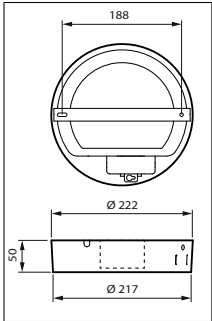

Photometric data

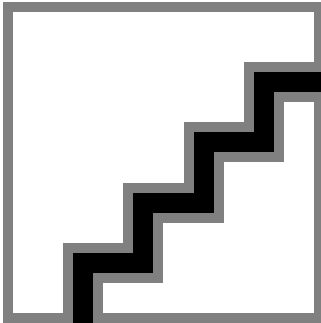

Polar Normal (separate) - null - 911401806580

